



MARKETING OFFICE

New Delhi: 70, KLJ Complex, 2nd Floor, Moti Nagar, New Delhi-110015, India
P: +91 11-45557000, 25107617, F: +91 11-45557050
E: merinodelhi@merinoindia.com, W: www.glossmeister.com



HIGH GLOSS PU + ACRYLIC PANEL



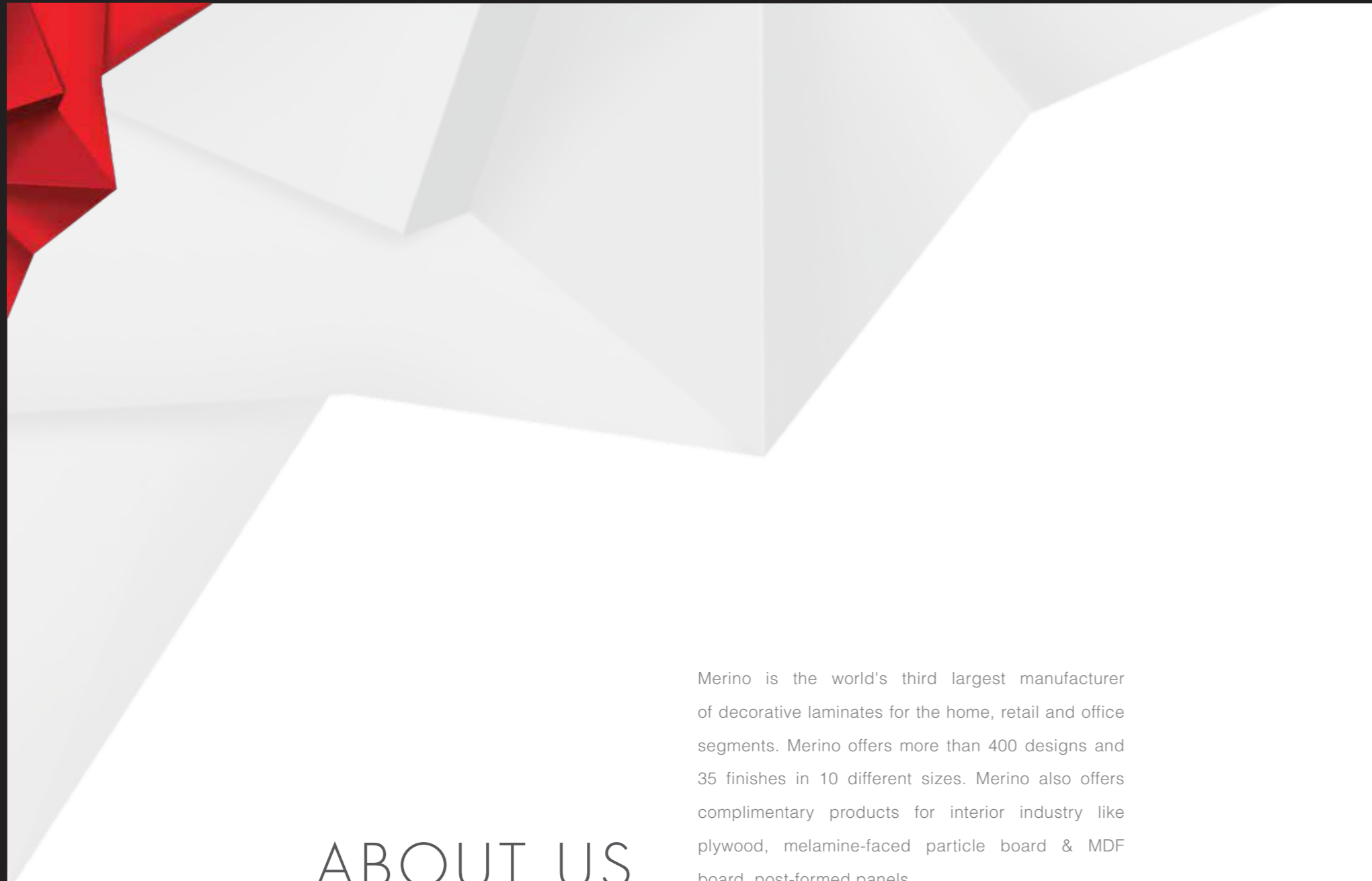

ABOUT US

Merino is the world's third largest manufacturer of decorative laminates for the home, retail and office segments. Merino offers more than 400 designs and 35 finishes in 10 different sizes. Merino also offers complimentary products for interior industry like plywood, melamine-faced particle board & MDF board, post-formed panels.



ABOVE ALL ELSE

Let every surface add shine to your home with the wide selection of Gloss Meister panels. Built with everlasting finesse, these high gloss PU + Acrylic Panels add the finishing touch you've always desired, making your home truly a cut above everyone else's.



THE MAKINGS OF A MEISTER

1—E1 GRADE MDF IS PROCURED.

2

A MELAMINE COATED DESIGN PAPER IS ADDED TO GIVE IT THE SURFACE STRENGTH TO BE ABRASION, MOISTURE AND IMPACT RESISTANT.

3

A PU+ HOT COATING IS APPLIED TO THE SURFACE FOR BETTER PREVENTION OF CRACKS AND DELAMINATION.

4

MULTIPLE LAYERS OF HOT COATING ARE FURTHER ADDED TO GIVE IT THE DISTINCT HIGH GLOSS FINISH THAT MAKES IT THE BEST-IN-CLASS.

5

EACH ACRYLIC LAYER IS UV CURED, HARDENING THE SURFACE FURTHER AND MAKING IT RESISTANT TO CHEMICALS.

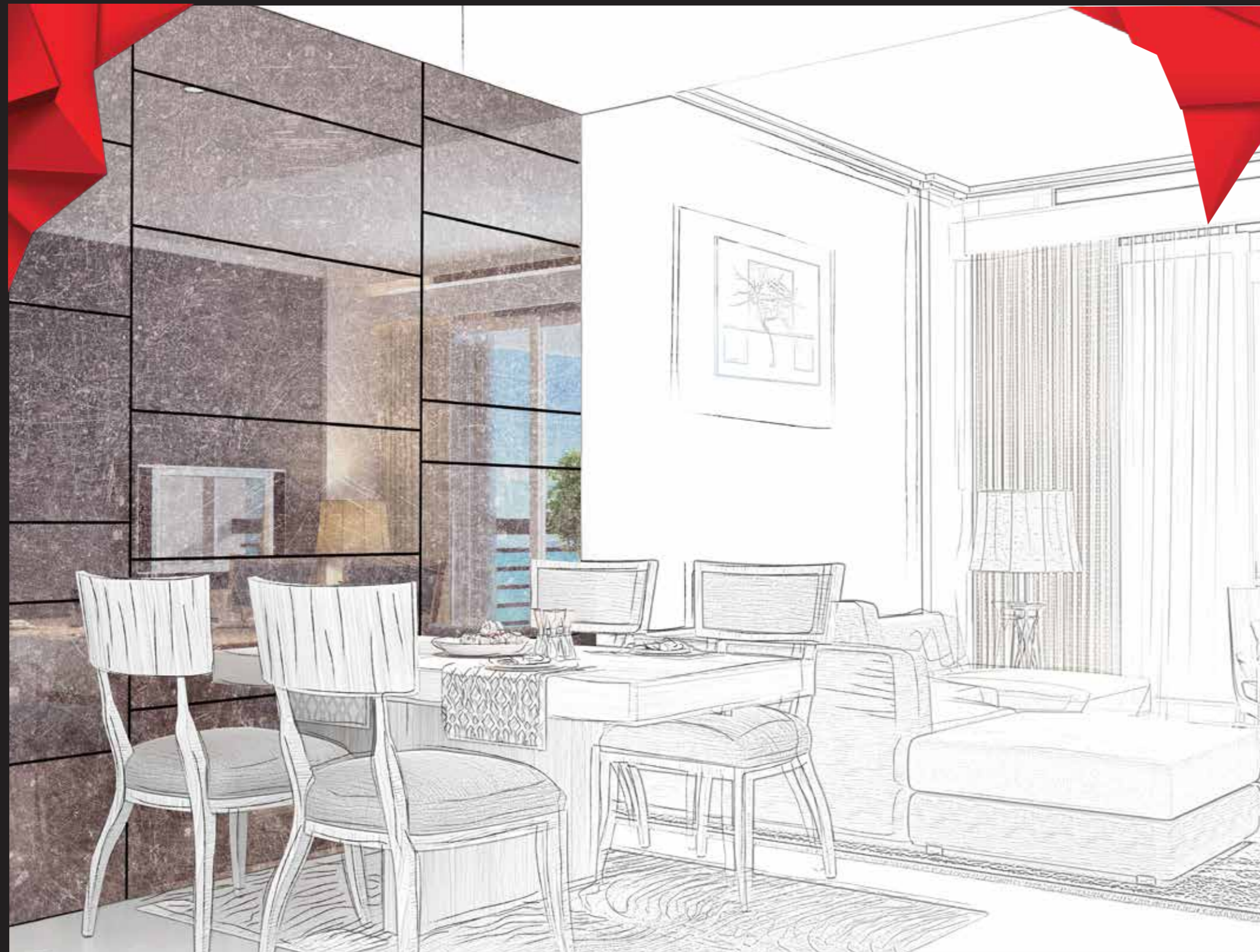

22099 SLATE

44760 AGGIES MICAS

21027 IRISH CREAM

21082 CELESTIAL BLUE

44762 ALLIES MICAS

40267 GOLDEN CAMPINO

22127 BROWN

22137 CAPPUCCINO

21132 BLUE DANUBE

EXPRESSIONS 2017

Meister of the new. Meister of the now.

The Meister is all about the now and the new. And that's why it offers you a brand new collection. The new range is an assortment of colours that express every mood. From the relaxed serenity of the Blues to the freshness of the Coffees, from the warmth of the Browns to the cool of the Micas, this collection captures every mood and expresses it with style.

RE NO.: REHAU EDGE BANDING NUMBER

Recommended for vertical applications



PRODUCT RANGE SOLIDS



RE NO: REHAU EDGE BANDING NUMBER

Recommended for vertical applications
RE No. 75637



PRODUCT RANGE WOOD

10502 ELEVATED WOOD

RE No. 337P

RE No. 310P

10019 SAPELLE

14178 CHERRY WALNUT

RE No. 315P

14613 DOREDOS PINE

Recommended for vertical applications

RE No. 331P

RE NO.: REHAU EDGE BANDING NUMBER



RE NO. REHAU EDGE BANDING NUMBER

PRODUCT RANGE PATTERNS

49944 SILVER FROST

RE No. 4523

49951 STEEL PEARL

49957 DARK DACRON

49958 LIGHT DACRON

Recommended for vertical applications
RE No. 210P



EXCELLENCE THAT SHINES OUT

Whether you desire to create a unique personal space or an extraordinary professional design, Gloss Meister High Gloss Pu + Acrylic Panels will offer great features to create spaces with breathtaking beauty. The Lustrous mirror like finish of Gloss Meister capture surrounding reflection and ensures perfectly smooth surfaces to give any space a distinctive and contemporary look.



Gloss Meister High Gloss Pu + Acrylic Panels are extremely easy to cut and drill without any chipping. This unique attribute makes these panels highly elastic and easy to process for various applications ranging from residential to commercial usage. Gloss Meister Panels are soon going to be the first preference of end consumers and interior specialist.

MODULAR KITCHEN, OFFICE FURNITURE, WARDROBES, RETAIL SHOWROOM
FIXTURE, HOME FURNITURE, HOSPITALITY & WELLNESS, INTERNAL WALL CLADDING

APPLICATIONS

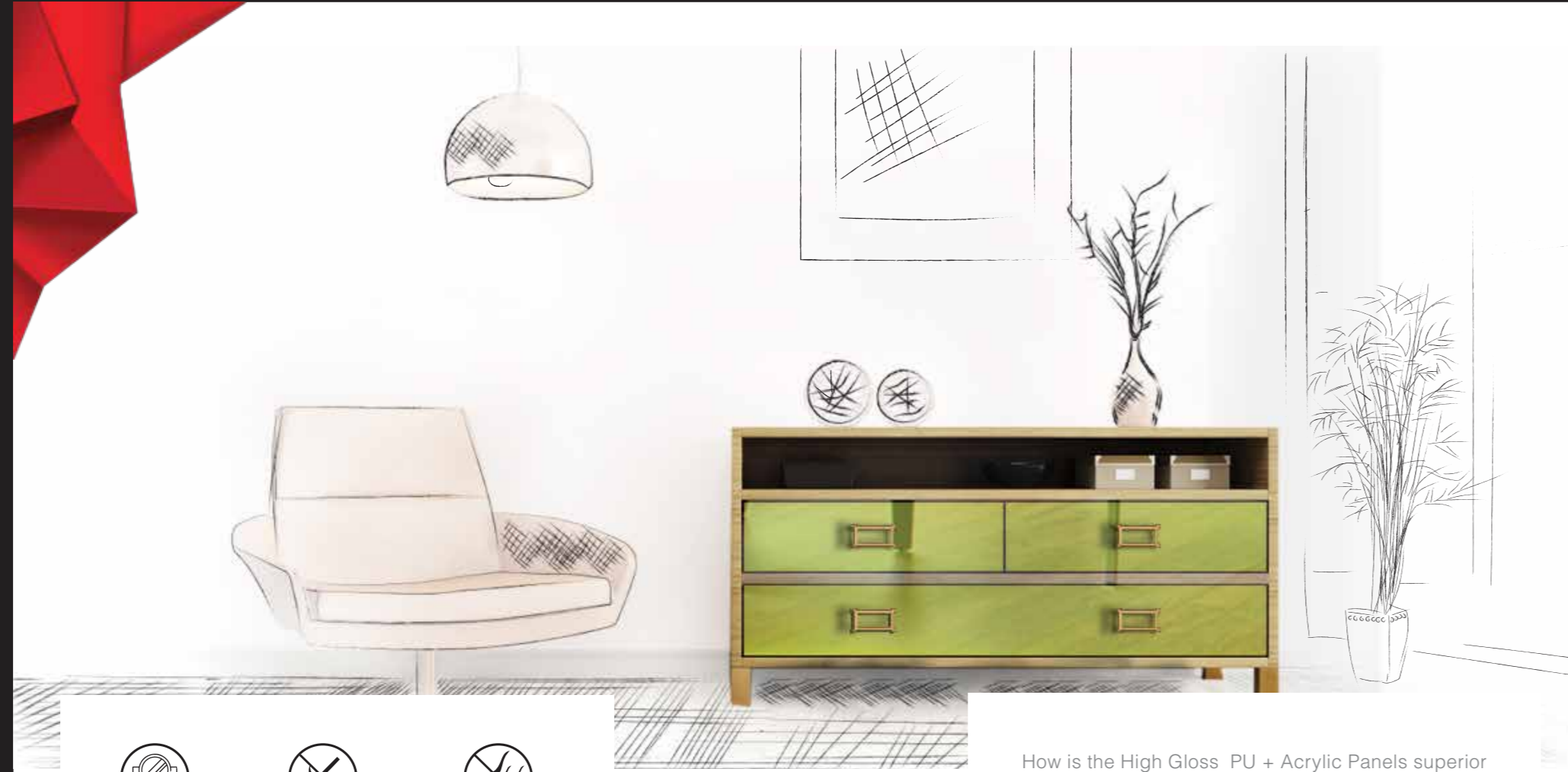

Mirror Like Finish



Impact Resistance



Scratch Resistance

TECHNOLOGY THAT'S UNMATCHED

How is the High Gloss PU + Acrylic Panels superior to other substitutes? It has been developed with a cutting edge, innovative process that combines German expertise with Modern PU coating. PU+ is a modified PU reinforced with Acrylic Polymer thereby achieving best properties of both PU and Acrylic. This process overcomes the limitations of exiting PU coated high Gloss panels and provides Gloss Meister the advantage of superior gloss with high scratch, abrasion and impact resistance.

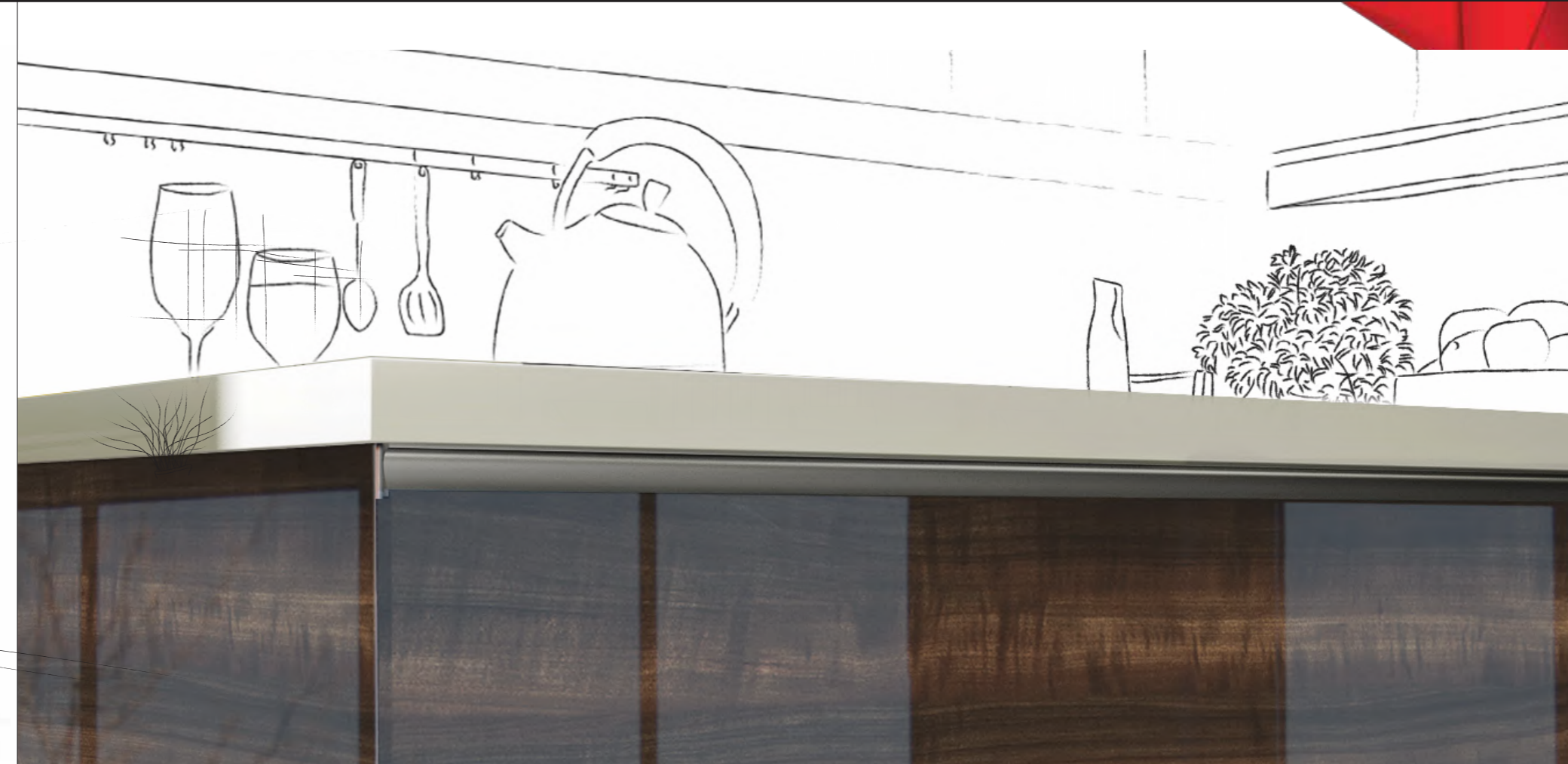

THAT'S EXCEPTIONAL



EASY TO PROCESS

It is very easy to work upon these panels. The high elasticity of these panels makes them extremely easy to cut and drill without any chipping



SCRATCH RESISTANCE

Superior PU+ Coating makes these panels the most scratch resistant high gloss surface available



IMPACT RESISTANCE

Forget the worries of surface Delamination or White Breaking. PU+ Coating layers guarantees impeccable surface strength



AESTHETIC VALUE

Be spoilt for choice with more than 400 designs to choose from, including Woodgrain, Patterns, Metallic, Abstract, etc.



NO YELLOWING EFFECT

Because of special construction of PU+ layers, it guarantees that there will not be any yellowing effect, thereby maintaining its colour over a long period



HIGH ABRASION RESISTANCE

Special Top layer of PU+ provides higher abrasion resistance as compared to other coated surfaces available

FABRICATION GUIDELINES

▶ CUTTING

GLOSS MEISTER HIGH GLOSS PU + ACRYLIC PANELS CAN BE CUT ON-

1. CNC Cutting – To get the best results for cutting on Gloss Meister High Gloss PU + Acrylic Panels, it is recommended to be cut on a CNC Cutter.

- a. Tool – preferably Sharp solid carbide tools
- b. Feed Speed – Moderate feed speed of approx 20 -25 metres / min.
- c. Cutting Speed – High cutting spindle speed of approx 20K rpmt

2. Beam Saw – When using beam saw to cut Gloss Meister Panels, please ensure that blade used is sharp.

- a. Tool - preferably Sharp solid carbide tipped blades with 3 to 5 Teeth per cm
- b. Only fresh or grinded tools to be used
- c. Speed - i. Main Saw - 4000 rpm
ii. Feed - 25 mts / min
- d. Always use scourer blade to avoid chipping at the back side of the panel.

▶ DRILLING

- a. Use steel or carbide based drills
- b. Use a tipping angle of 100 to 120 degrees
- c. Adjust the speed to avoid overheating of the panel.

▶ HINGE SPECIFICATIONS

SN	Height		No of Hinges
	From (mm)	To (mm)	
1	0	850	2
2	851	1350	3
3	1351	1800	4
4	1801	2400	5

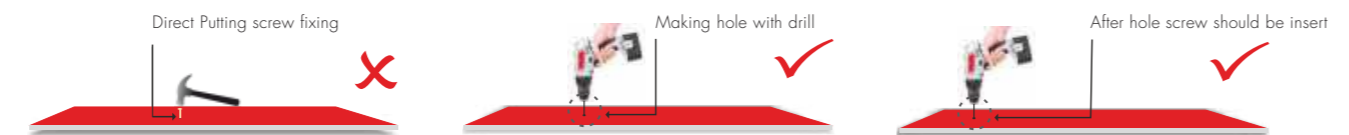

Direct putting screw in the panel is prohibited, instead a hole should be made with drill and then screw should be inserted (care to be taken that diameter of the hole should be 0.5mm less than the diameter of the screw).

CLEANING & MAINTENANCE

▶ CLEANING PROCEDURE

- a. Normal Cleaning : Clean the surface of Gloss Meister with few drops of warm water and wipe the same with a soft cloth. If required, use a few drops of mild detergent or glass cleaner. Finish the cleaning with wiping dry with a soft cloth (micro fibre cloth).
- b. Stains : Stains generated by strong dyes / colours / chemicals or fat / oil are to be removed using lot of water and if required, use normal, non abrasive household cleaners. This is followed by cleaning with lukewarm water so that any residual soap, etc can be removed. Stains, in particular, should be removed immediately and should not be allowed to dry.
- c. Stubborn Stains – They should be removed using ordinary plastic cleaner or glass cleaner. Please test the cleaning product in a small area before applying in full.

▶ NOT RECOMMENDED

- a. Cleaning agents having –
 - i. High acid contents
 - ii. Self cleaning properties
 - iii. Abrasive characteristics
 - iv. High volatile contents
 - v. Solvent Based cleaners
- b. Do not apply
 - Abrasive cleaners, pads or powder; brushes
 - Floor Wax
 - Acetone, etc.
 - Sponge Scourers
 - Methylated Spirits
 - Cloths other
 - Polish
 - Thinner
 - Steel Wool
 - Bleach
 - Petrol or oil based cleaners

▶ NEVER DRY WIPE AND AVOID PAPER TOWEL OR TISSUE PAPER AT ANY POINT OF TIME.

MATERIAL HANDLING DURING TRANSPORTATION

- ▶ GLOSS MEISTER HIGH GLOSS PU + ACRYLIC PANELS SHOULD NOT BE PUSHED & PULLOUT.

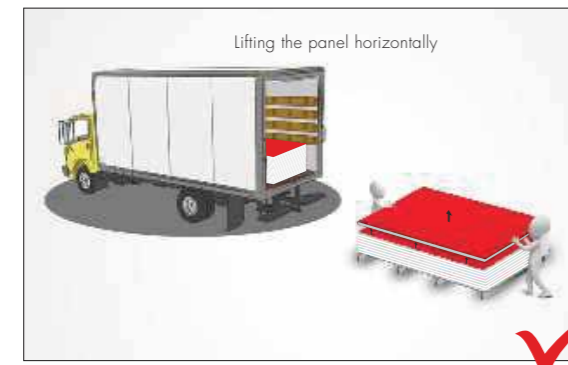

In cases where the raised compact platform is not provided / used, it is mandatory that the bottom laminate cover is stacked on a plastic Tarpaulin sheet

- ▶ GLOSS MEISTER HIGH GLOSS PU + ACRYLIC PANELS SHOULD BE LIFTED PARALLEL FROM ALL CORNERS.



Merino Gloss Meister High Gloss PU + Acrylic panels should be lifted parallel from all corners.

- ▶ MERINO GLOSS MEISTER HIGH GLOSS PU + ACRYLIC PANELS ALWAYS PLACE HORIZONTALLY



MATERIAL HANDLING DURING STORAGE

Gloss Meister High gloss PU + Acrylic Panels have very high density, hence even slightest difference of moisture absorption between two sides will result warpage immediately. This is why it is common to find warpage issues in compact boards stacked at the top or bottom. Through proper precautions in storage, the problem of warpage can be avoided to a greater extent.

► STACKING OF GLOSS MEISTER HIGH GLOSS PU + ACRYLIC PANELS.

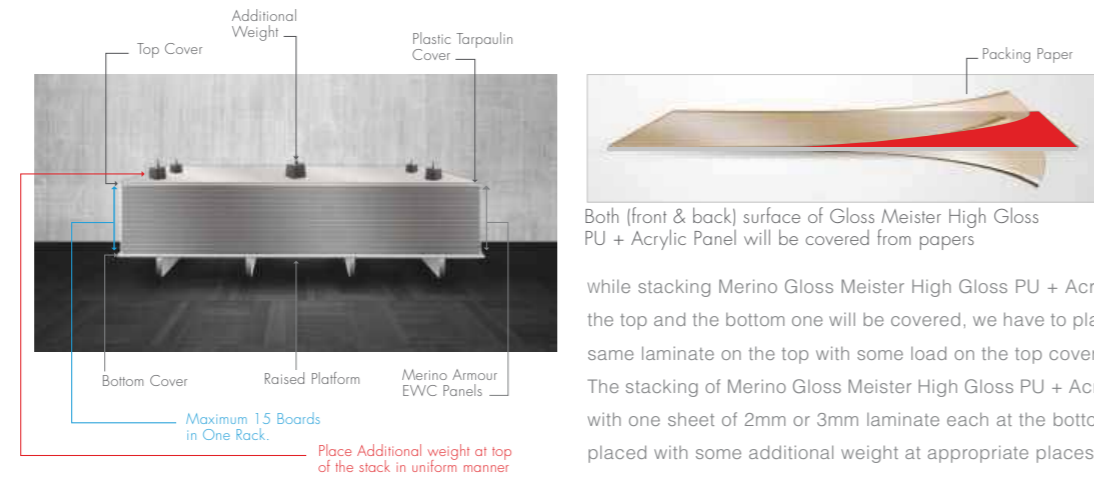

Both (front & back) surface of Gloss Meister High Gloss PU + Acrylic Panel will be covered from papers

while stacking Merino Gloss Meister High Gloss PU + Acrylic Panels, as both surfaces of all laminates except the top and the bottom one will be covered, we have to place one 2mm or 3mm laminate at the bottom and one same laminate on the top with some load on the top cover.

The stacking of Merino Gloss Meister High Gloss PU + Acrylic Panels in supply of up to 15 boards will be done with one sheet of 2mm or 3mm laminate each at the bottom and the top. The top cover in all cases should be placed with some additional weight at appropriate places and in uniform manner.

► MERINO GLOSS MEISTER HIGH GLOSS PU + ACRYLIC PANELS SHOULD BE ABSOLUTELY PARALLEL TO EACH OTHER IN RACK

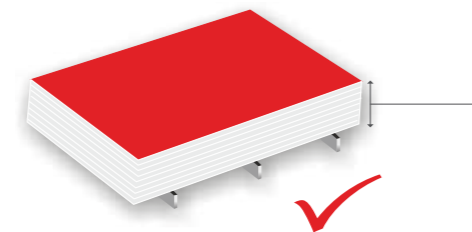

Gloss Meister Panels are Parallel to each other from all Corners / Sides.

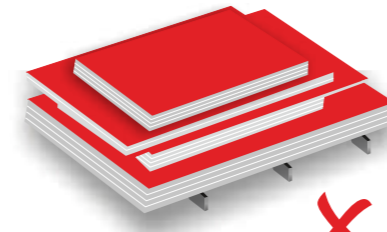

Unparallel Corners / Sides.

► USE ONE STACK FOR SINGLE SIZES PANELS.

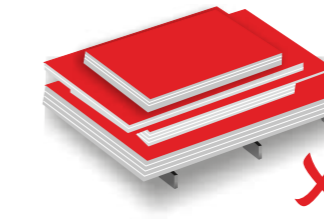
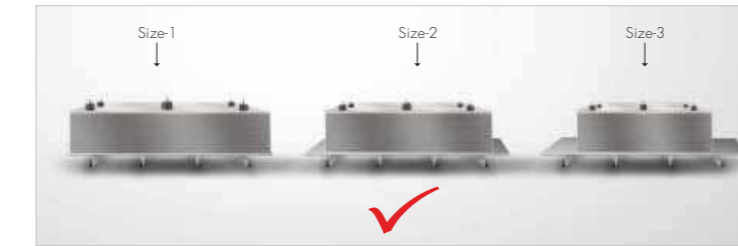

Same sizes Merino Gloss Meister High Gloss PU + Acrylic Panels should be stacked in one stack so that excess or shortages will not be there from any side in one stack.

► WHERE THE STORAGE AREA IS LESS.

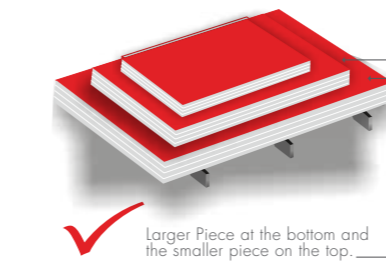

Larger Piece at the bottom and the smaller piece on the top.

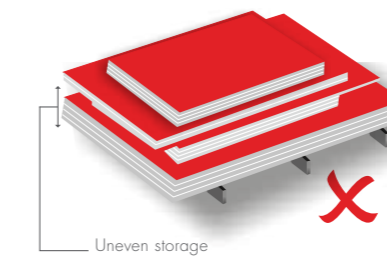

Uneven storage

In cases where the space provided for storage is less, the stacking should be done in such a manner that the larger pieces are at the bottom and the smaller pieces are on the top.

► COVER ENTIRE MATERIAL FROM PLASTIC TARPULIN COVER.

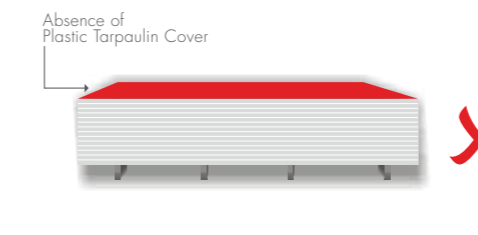
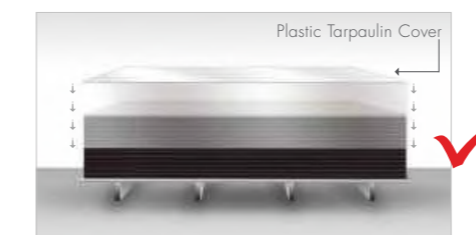

In cases where the raised compact platform is not provided / used, it is mandatory that the bottom laminate cover is stacked on a plastic Tarpaulin sheet.

APPLICATION: WALL PANELING ADHESIVE BASED SYSTEM

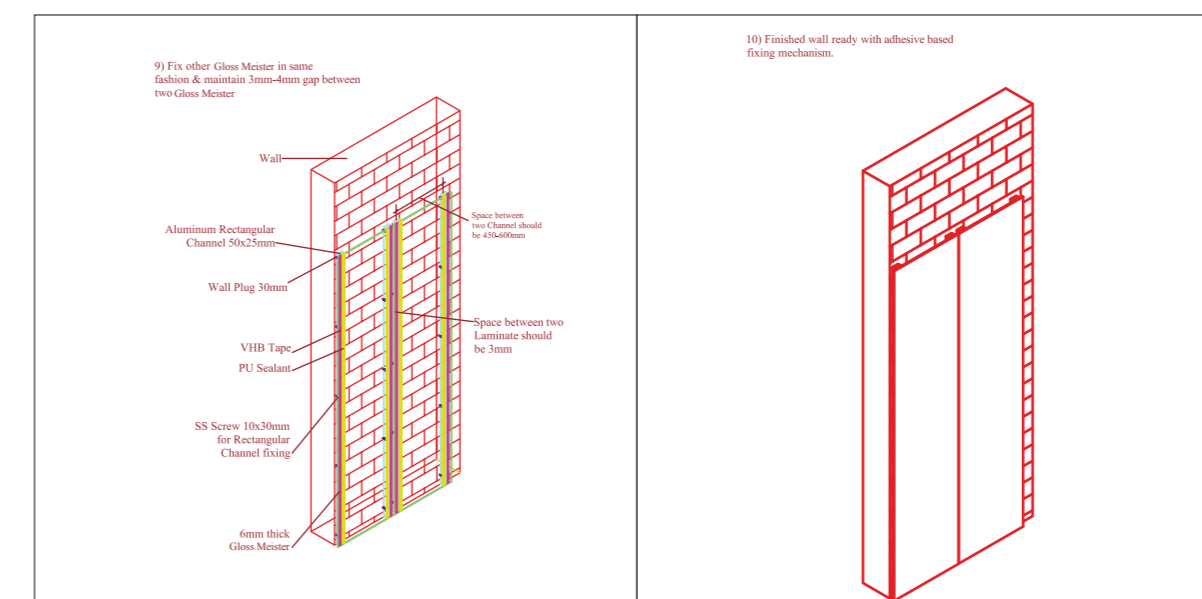
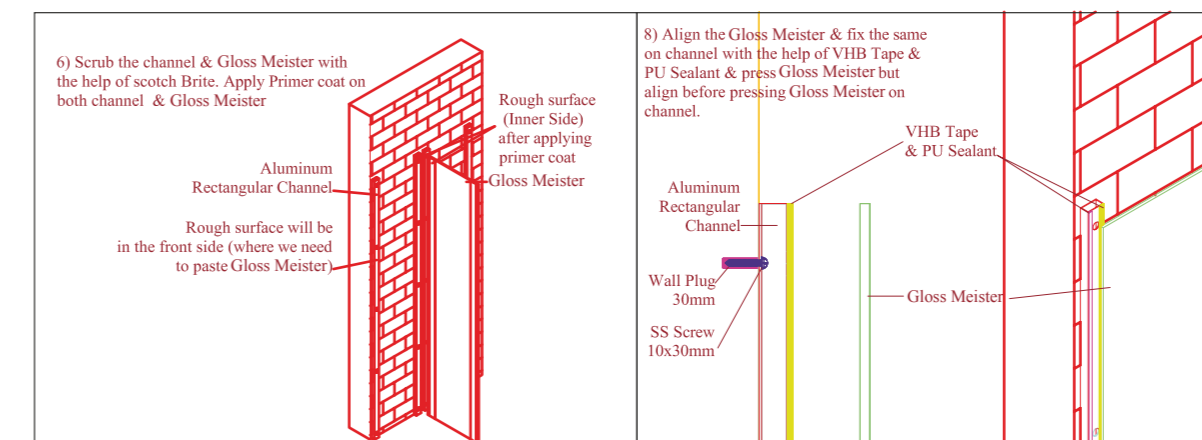
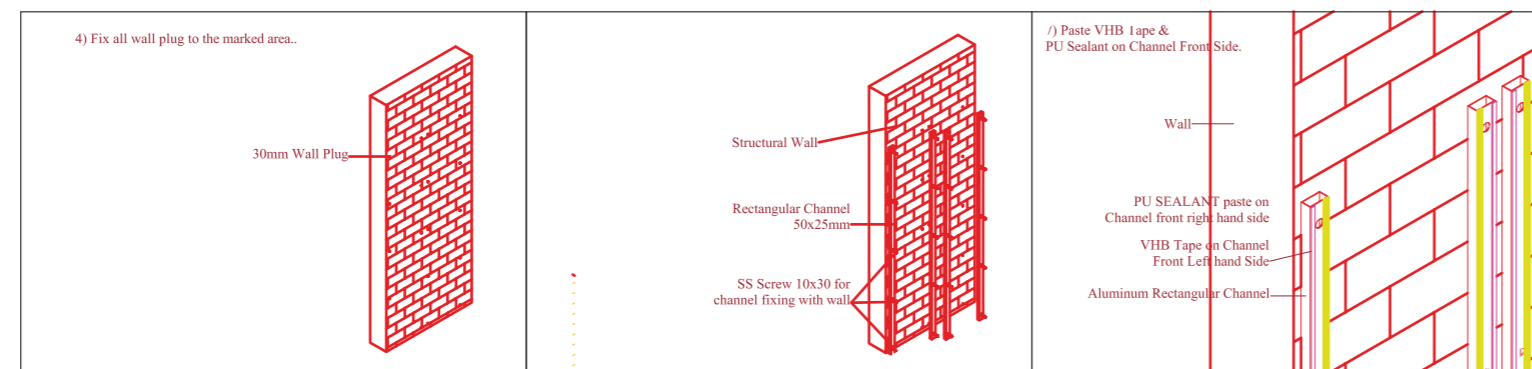
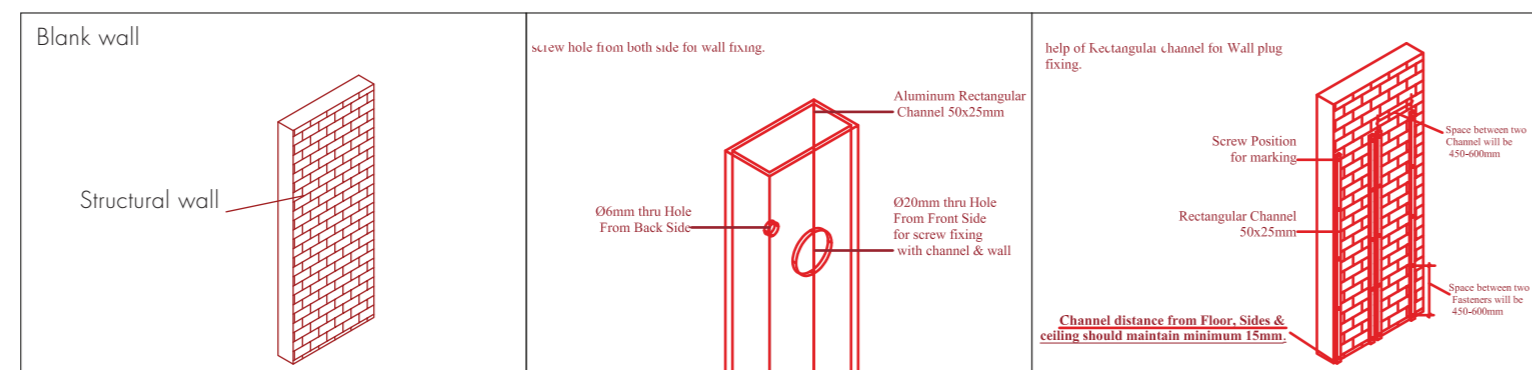

APPLICATION: VERTICAL PARTITION U CHANNEL

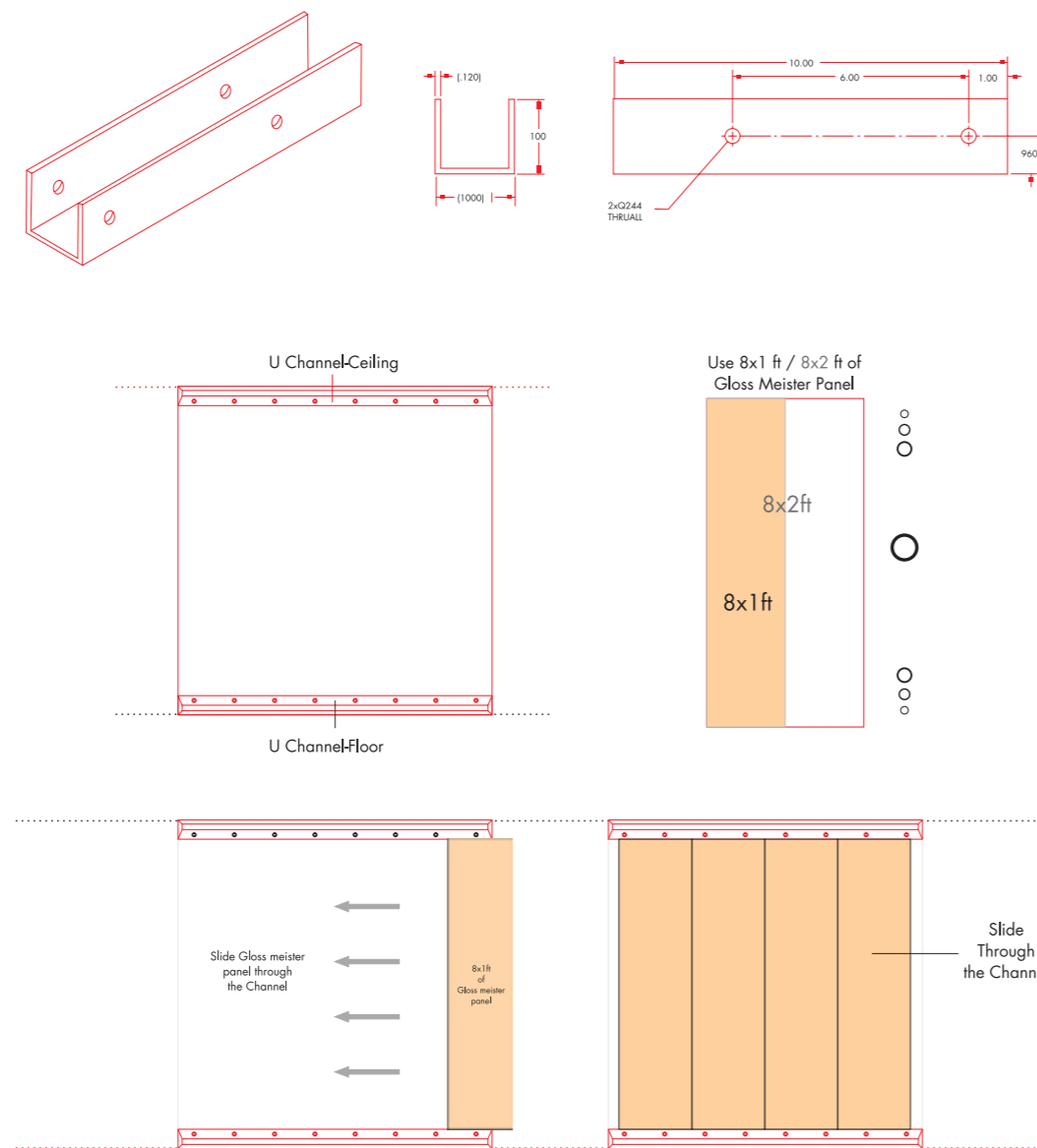

TECHNICAL DATA SHEET

Sl No	Parameters	Standard	Unit	Merino Value
1	Thickness Variation	IHD-W- 454	mm	±0.5mm
2	Density	EN-323	kg/m ³	725
3	Dimension Tolerance	EN-324-1	mm	+/- 0.5
4	Micro Scratch Resistance(Martindale)	IHD-W-466	Rating	Class 1, Loss of Gloss <20 %
5	Adhesion (Cross Cut)	IHD-W-464	Rating	0
6	Gloss Level at 60° angle	EN 14323	level	>93
7	DOI Value	RHO Point Meter	level	>93
8	RIQ Value	RHO Point Meter	level	>75
9	Abrasion Resistance	IHD-5-461	Class	Stress Class-3
10	Resistance to Food & Chemicals	IHD-W-460	Grading	5
11	Light Fastness	Grey scale EN 14323	Rating	>4
12	Resistance to water Steam	EN 14323	Rating	>4
13	Resistance to Dry Heat	EN-438	Rating	>5
14	Cracking	EN 14323	Rating	>5
15	Resistance to Impact Stress (Large Diameter steel wall)	EN 14323	cm	>100 cm
16	Modulus of Rupture	EN-310	N/mm ²	>27
17	Internal Bonding	EN-319	N/mm ²	>0.75
18	Screw Withdrawal Face--- Edge---	EN-320	NA	>1500 >900
19	Formaldehyde content(E1)	EN-120	mg/100gm	≈8mg/100gm
20	Scratch Resistance BYK Gardner 12403	DIN 68861 T4	NA	2.5

Specification Language

Gloss Meister High Gloss PU + Acrylic Panel is a 2440 mm x 1220 mm x 18mm decorative high gloss lacquered panel with modified Poly Urethane coating reinforced with acrylic polymer on double faced Melamine E1 grade MDF Board for interior applications.